

For use with aggressive media and in areas susceptible to corrosive outside influences, in the food processing industry and in hygienic and sanitary applications.

Material	Stainless steel 1.4404
Sealant	FPM
Pressure	max. 15 bar (depending on pipe quality)
Working pressure pulsate:	max. 10 bar
Medium and operating temperature:	-20 °C to max. 150 °C (depending on pipe quality and diameter)
Suitable pipe materials:	PVDF, PTFE, PA, PU

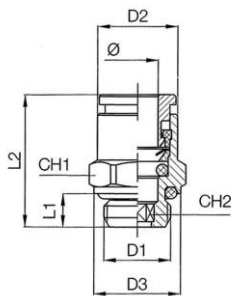

44.018-4 ES

Male connector, parallel male thread with O-ring (FPM) and outer hex

Art. No.	Type No.	For tube O.D. mm	D1 mm	D2 mm	D3 mm	L1 mm	L2 mm	CH1 mm	CH2 mm	weight (g)
110359	44.005-4 ES	4	M5	9.0	8.0	4.0	19.0	9	-	4.9
Art. No. 110359 = discontinued product. No longer available. New product 135058 (844.005-4 ES)										
110360	44.018-4 ES	4	G 1/8	9.0	13.0	5.0	16.6	13	3	8.0
Art. No. 110360 = discontinued product. No longer available. New product 135059 (844.018-4 ES)										
110361	44.018-6 ES	6	G 1/8	12.0	13.0	5.0	19.7	13	4	10.0
Art. No. 110361 = discontinued product. No longer available. New product 135060 (844.018-6 ES)										
110362	44.018-8 ES	8	G 1/8	14.0	13.0	5.0	23.2	14	6	12.5
Art. No. 110362 = discontinued product. No longer available. New product 135061 (844.018-8 ES)										
110363	44.014-6 ES	6	G 1/4	12.0	16.0	6.5	19.7	16	4	15.5
Art. No. 110363 = discontinued product. No longer available. New product 135063 (844.014-6 ES)										
110364	44.014-8 ES	8	G 1/4	14.0	16.0	6.5	21.7	16	6	15.5
Art. No. 110364 = discontinued product. No longer available. New product 135064 (844.014-8 ES)										
110365	44.014-10 ES	10	G 1/4	16.0	16.0	6.5	27.2	16	8	39.0
Art. No. 110365 = discontinued product. No longer available. New product 135065 (844.014-10 ES)										
110366	44.038-10 ES	10	G 3/8	16.0	20.0	7.0	24.7	17	8	39.0
Art. No. 110366 = discontinued product. No longer available. New product 135068 (844.038-10 ES)										
110367	44.038-12 ES	12	G 3/8	19.0	20.0	7.0	27.9	21	10	32.0
Art. No. 110367 = discontinued product. No longer available. New product 135069 (844.038-12 ES)										
110368	44.012-12 ES	12	G 1/2	19.0	25.0	8.5	26.4	22	10	39.0
Art. No. 110368 = discontinued product. No longer available. New product 135072 (844.012-12 ES)										

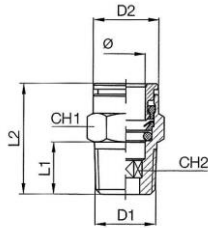

45.018-8 ES

Male connector, conical male thread with outer hex

Art. No.	Type No.	For tube O.D. mm	D1 mm	D2 mm	L1 mm	L2 mm	CH1 mm	CH2 mm	weight (g)
110369	45.018-4 ES	4	R 1/8	9.0	7.0	16.6	10	3	6.0
Art. No. 110369 = discontinued product. No longer available. New product 135075 (845.018-4 ES)									
110370	45.018-6 ES	6	R 1/8	12.0	6.9	21.2	12	4	9.0
Art. No. 110370 = discontinued product. No longer available. New product 135076 (845.018-6 ES)									
110371	45.018-8 ES	8	R 1/8	14.0	6.8	25.2	14	6	13.5
Art. No. 110371 = discontinued product. No longer available. New product 135077 (845.018-8 ES)									
110372	45.014-4 ES	4	R 1/4	9.0	10.0	20.6	14	3	16.0
Art. No. 110372 = discontinued product. No longer available. New product 135078 (845.014-4 ES)									
110373	45.014-6 ES	6	R 1/4	12.0	11.0	20.7	14	4	14.0
Art. No. 110373 = discontinued product. No longer available. New product 135079 (845.014-6 ES)									
110374	45.014-8 ES	8	R 1/4	14.0	11.0	23.7	14	6	14.0
Art. No. 110374 = discontinued product. No longer available. New product 135080 (845.014-8 ES)									
110375	45.014-10 ES	10	R 1/4	16.0	11.0	30.3	16	8	20.0
Art. No. 110375 = discontinued product. No longer available. New product 135081 (845.014-10 ES)									
110376	45.038-10 ES	10	R 3/8	16.0	11.5	23.5	17	8	21.0
Art. No. 110376 = discontinued product. No longer available. New product 135084 (845.038-10 ES)									
110377	45.038-12 ES	12	R 3/8	18.0	11.5	27.4	19	10	26.0
Art. No. 110377 = discontinued product. No longer available. New product 135085 (845.038-12 ES)									
110378	45.012-12 ES	12	R 1/2	18.0	14.0	27.4	22	10	41.0

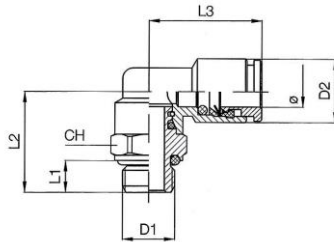

43.014-6 ES

Male elbow, swivel type, parallel male thread with O-ring (FPM)

Art. No.	Type No.	For tube O.D. mm	D1 mm	D2 mm	L1 mm	L2 mm	L3 mm	CH mm	weight (g)
110379	43.005-4 ES	4	M5	9.0	4.0	14.8	17.0	9	8.7
Art. No. 110379 = discontinued product. No longer available. New product 135123 (843.005-4 ES)									
110380	43.018-4 ES	4	G 1/8	9.0	5.0	16.0	17.0	13	12.0
Art. No. 110380 = discontinued product. No longer available. New product 135124 (843.018-4 ES)									
110381	43.018-6 ES	6	G 1/8	12.0	5.0	18.0	21.5	13	20.0
Art. No. 110381 = discontinued product. No longer available. New product 135125 (843.018-6 ES)									
110382	43.018-8 ES	8	G 1/8	14.0	5.0	18.0	22.0	13	22.0
Art. No. 110382 = discontinued product. No longer available. New product 135126 (843.018-8 ES)									
110383	43.014-6 ES	6	G 1/4	12.0	6.5	20.0	21.5	16	24.0
Art. No. 110383 = discontinued product. No longer available. New product 135128 (843.014-6 ES)									
110384	43.014-8 ES	8	G 1/4	14.0	6.5	20.0	22.0	16	25.5
Art. No. 110384 = discontinued product. No longer available. New product 135129 (843.014-8 ES)									
110385	43.014-10 ES	10	G 1/4	16.0	6.5	22.5	25.5	16	35.0
Art. No. 110385 = discontinued product. No longer available. New product 135130 (843.014-10 ES)									
110386	43.038-10 ES	10	G 3/8	16.0	7.0	24.0	25.5	21	42.0
Art. No. 110386 = discontinued product. No longer available. New product 135133 (843.038-10 ES)									
110387	43.038-12 ES	12	G 3/8	19.0	7.0	26.5	28.0	21	60.0
Art. No. 110387 = discontinued product. No longer available. New product 135134 (843.038-12 ES)									
110388	43.012-12 ES	12	G 1/2	19.0	8.5	31.0	28.0	22	81.0
Art. No. 110388 = discontinued product. No longer available. New product 135137 (843.012-12 ES)									

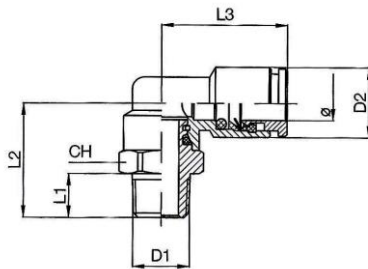

54.018-4 ES

Male elbow, swivel type, conical male thread

Art. No.	Type No.	For tube O.D. mm	D1 mm	D2 mm	L1 mm	L2 mm	L3 mm	CH mm	weight (g)
110389	54.018-4 ES	4	R 1/8	9.0	7.5	17.5	17.0	10	11.0
Art. No. 110389 = discontinued product. No longer available. New product 135140 (854.018-4 ES)									
110390	54.018-6 ES	6	R 1/8	12.0	7.5	20.0	21.5	13	21.0
Art. No. 110390 = discontinued product. No longer available. New product 135141 (854.018-6 ES)									
110391	54.018-8 ES	8	R 1/8	14.0	7.5	20.0	22.0	13	22.5
Art. No. 110391 = discontinued product. No longer available. New product 135142 (854.018-8 ES)									
110392	54.014-6 ES	6	R 1/4	12.0	11.0	24.0	21.5	14	25.0
Art. No. 110392 = discontinued product. No longer available. New product 135144 (854.014-6 ES)									
110393	54.014-8 ES	8	R 1/4	14.0	11.0	24.0	22.0	14	26.5
Art. No. 110393 = discontinued product. No longer available. New product 135145 (854.014-8 ES)									
110394	54.014-10 ES	10	R 1/4	16.0	11.0	26.5	25.5	16	37.0
Art. No. 110394 = discontinued product. No longer available. New product 135146 (854.014-10 ES)									
110395	54.038-10 ES	10	R 3/8	16.0	11.5	27.0	25.5	17	40.0
Art. No. 110395 = discontinued product. No longer available. New product 135149 (854.038-10 ES)									
110396	54.038-12 ES	12	R 3/8	18.0	11.5	30.5	28.0	22	61.5
Art. No. 110396 = discontinued product. No longer available. New product 135150 (854.038-12 ES)									
110397	54.012-12 ES	12	R 1/2	18.0	14.0	33.5	28.0	22	66.0
Art. No. 110397 = discontinued product. No longer available. New product 135153 (854.012-12 ES)									

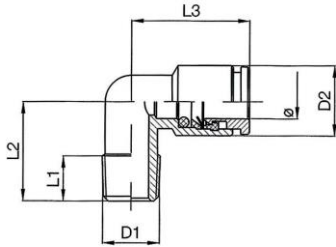

52.014-6 ES

Male elbow conical male thread

Art. No.	Type No.	For tube O.D. mm	D1 mm	D2 mm	L1 mm	L2 mm	L3	weight (g)
110398	52.018-4 ES	4	R 1/8	9.0	7.5	16.0	17.0	10.5
Art. No. 110398 = discontinued product. No longer available. New product 135156 (852.018-4 ES)								
110399	52.018-6 ES	6	R 1/8	12.0	7.5	16.0	20.0	14.0
Art. No. 110399 = discontinued product. No longer available. New product 135157 (852.018-6 ES)								
110400	52.018-8 ES	8	R 1/8	14.0	7.5	17.0	21.0	19.0
110401	52.014-6 ES	6	R 1/4	12.0	11.0	20.0	20.0	21.0
Art. No. 110401 = discontinued product. No longer available. New product 135160 (852.014-6 ES)								
110402	52.014-8 ES	8	R 1/4	14.0	11.0	20.0	21.0	22.0
110403	52.014-10 ES	10	R 1/4	16.0	11.0	22.5	25.5	39.5

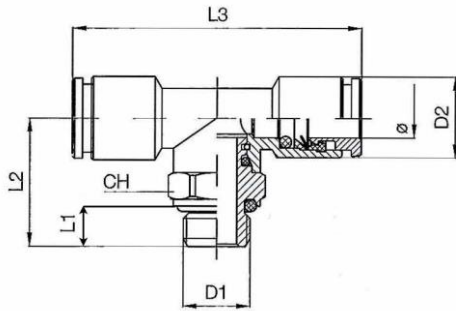

55.014-8 ES

Male branch tee, swivel type, parallel male thread with O-ring (FPM)

Art. No.	Type No.	For tube O.D. mm	D1 mm	D2 mm	L1 mm	L2 mm	L3 mm	CH mm	weight (g)
110404	55.005-4 ES	4	M5	9.0	4.0	18.0	34.0	9	14.0
Art. No. 110404 = discontinued product. No longer available. New product 135172 (855.005-4 ES)									
110405	55.018-4 ES	4	G 1/8	9.0	5.0	20.0	34.0	13	17.0
110406	55.018-6 ES	6	G 1/8	12.0	5.0	22.5	42.0	13	29.0
110407	55.018-8 ES	8	G 1/8	14.0	5.0	22.5	43.0	13	30.5
110408	55.014-6 ES	6	G 1/4	12.0	6.5	24.5	42.0	16	33.0
Art. No. 110408 = discontinued product. No longer available. New product 135177 (855.014-6 ES)									
110409	55.014-8 ES	8	G 1/4	14.0	6.5	24.5	43.0	16	34.5
110410	55.014-10 ES	10	G 1/4	16.0	6.5	25.5	50.0	16	57.0
110411	55.038-10 ES	10	G 3/8	16.0	7.0	27.0	50.0	21	64.0

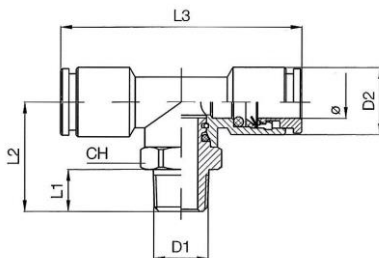

755.014-6 ES

Male branch tee, swivel type, conical male thread

Art. No.	Type No.	For tube O.D. mm	D1 mm	D2 mm	L1 mm	L2 mm	L3 mm	CH mm	weight (g)
110412	755.018-4 ES	4	R 1/8	9.0	7.5	21.5	34.0	10	15.5
Art. No. 110412 = discontinued product. No longer available. New product 135189 (8755.018-4 ES)									
110413	755.018-6 ES	6	R 1/8	12.0	7.5	24.5	42.0	13	30.0
110414	755.018-8 ES	8	R 1/8	14.0	7.5	24.5	43.0	13	31.5
110415	755.014-6 ES	6	R 1/4	12.0	11.0	28.5	42.0	14	34.0
110416	755.014-8 ES	8	R 1/4	14.0	11.0	28.5	43.0	14	35.5
110417	755.014-10 ES	10	R 1/4	16.0	11.0	32.0	50.0	16	58.5
110418	755.038-10 ES	10	R 3/8	16.0	11.5	32.5	50.0	17	61.5
Art. No. 110418 = discontinued product. No longer available. New product 135198 (8755.038-10 ES)									

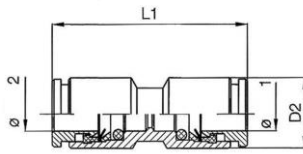

47.010 ES

Union

Art. No.	Type No.	For tube O.D. 1 mm	For tube O.D. 2 mm	D2 mm	L1 mm	weight (g)
110419	47.004 ES	4	4	9.0	28.2	7.5
Art. No. 110419 = discontinued product. No longer available. New product 135242 (847.004 ES)						
110420	47.006 ES	6	6	12.0	34.0	16.0
Art. No. 110420 = discontinued product. No longer available. New product 135243 (847.006 ES)						
110421	47.008 ES	8	8	14.0	34.5	19.5
Art. No. 110421 = discontinued product. No longer available. New product 135244 (847.008 ES)						
110422	47.010 ES	10	10	16.0	38.2	24.5
Art. No. 110422 = discontinued product. No longer available. New product 135245 (847.010 ES)						
110423	47.012 ES	12	12	16.0	40.8	30.0
Art. No. 110423 = discontinued product. No longer available. New product 135246 (847.012 ES)						

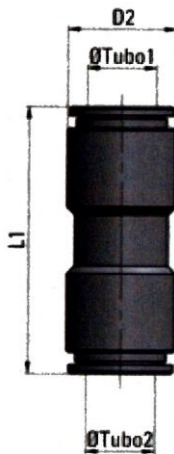

47.0806 ES

Reducer

Art. No.	Type No.	For tube O.D. 1 mm	For tube O.D. 2 mm	D2 mm	L1 mm	weight (g)
110424	47.0604 ES	6	4	12.0	31.0	15.5
Art. No. 110424 = discontinued product. No longer available. New product 135249 (847.0604 ES)						
110425	47.0806 ES	8	6	14.0	34.0	22.3
Art. No. 110425 = discontinued product. No longer available. New product 135250 (847.0806 ES)						

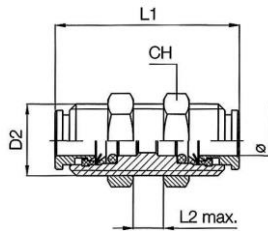

51.014-6 ES

Female bulkhead connector

Art. No.	Type No.	For tube O.D. mm	D2 mm	L1 mm	L2 _{max.} mm	CH mm	weight (g)
110426	51.012-4 ES	4	M12x1.0	28.0	11.0	15	24.0
Art. No. 110426= discontinued product. No longer available. New product 135255 (851.011-4 ES)							
110427	51.014-6 ES	6	M14x1.0	34.4	16.0	17	31.5
Art. No. 110427 = discontinued product. No longer available. New product 135256 (851.014-6 ES)							
110428	51.016-8 ES	8	M16x1.0	34.5	17.0	19	38.0
Art. No. 110428 = discontinued product. No longer available. New product 135257 (851.016-8 ES)							
110429	51.018-10 ES	10	M18x1.0	38.6	19.0	21	51.0
Art. No. 110429 = discontinued product. No longer available. New product 135258 (851.018-10 ES)							
110430	51.020-12 ES	12	M20x1.0	40.8	20.0	24	59.5

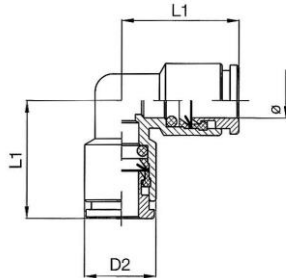

48.006 ES

Union elbow

Art. No.	Type No.	For tube O.D. mm	D2 mm	L1 mm	weight (g)
110431	48.004 ES	4	9.0	17.0	11.5
Art. No. 110431 = discontinued product. No longer available. New product 135262 (848.004 ES)					
110432	48.006 ES	6	12.0	20.0	18.0
Art. No. 110432 = discontinued product. No longer available. New product 135263 (848.006 ES)					
110433	48.008 ES	8	14.0	21.0	23.5
110434	48.010 ES	10	16.0	25.0	41.0
Art. No. 110434 = discontinued product. No longer available. New product 135265 (848.010 ES)					
110435	48.012 ES	12	18.0	27.0	44.0
Art. No. 110435 = discontinued product. No longer available. New product 135266 (848.012 ES)					

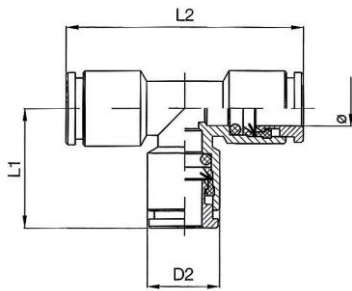

49.006 ES

Union tee

Art. No.	Type No.	For tube O.D. mm	D2 mm	L1 mm	L2 mm	weight (g)
110436	49.004 ES	4	9.0	17.0	35.0	14.0
110437	49.006 ES	6	12.0	20.0	42.0	29.5
Art. No. 110437 = discontinued product. No longer available. New product 135270 (848.006 ES)						
110438	49.008 ES	8	14.0	21.0	43.5	31.0
110439	49.010 ES	10	16.0	25.0	50.0	55.0
110440	49.012 ES	12	18.0	27.0	54.0	58.5

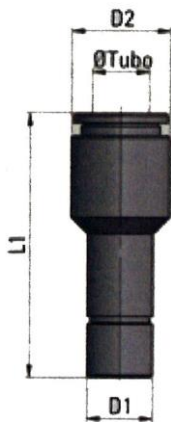

59.0806 ES

Reducer with push-in plug

Art. No.	Type No.	For tube O.D. mm	D1 mm	D2 mm	L1 mm	weight (g)
110441	59.0604 ES	4	6	9	31.0	6.5
110442	59.0806 ES	6	8	12	31.7	11.9
110443	59.1008 ES	8	10	14	34.5	14.8

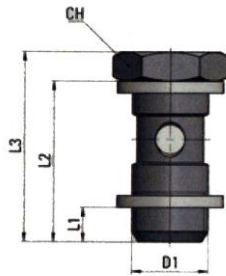

60.018 ES

Banjo bolt with PTFE seal, single

Art. No.	Type No.	D1 mm	L1 mm	L2 mm	L3 mm	CH mm	weight (g)
110444	60.018 ES	G 1/8	6.0	25.0	29.0	14	15.1
110445	60.014 ES	G 1/4	6.5	27.5	32.5	17	26.1
110446	60.038 ES	G 3/8	7.0	30.0	36.0	21	44.2
110447	60.012 ES	G 1/2	8.5	35.5	41.5	26	80.0

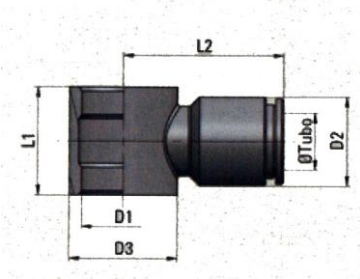

61.018-4 ES

Ring nipple, single

Art. No.	Type No.	For tube O.D. mm	D1 mm	D2 mm	D3 mm	L1 mm	L2 mm	weight (g)
110448	61.018-4 ES	4	G 1/8	9.0	14.0	15.0	20.5	13.1
110449	61.018-6 ES	6	G 1/8	12.0	14.0	15.0	22.0	16.0
110450	61.018-8 ES	8	G 1/8	14.0	14.0	15.0	22.5	18.7
110451	61.014-6 ES	6	G 1/4	12.0	17.2	17.2	23.5	16.6
110452	61.014-8 ES	8	G 1/4	14.0	17.0	17.0	24.5	20.4
110453	61.014-10 ES	10	G 1/4	16.0	17.2	17.2	26.0	23.0
110454	61.038-10 ES	10	G 3/8	16.0	22.0	20.0	29.0	35.4
110455	61.038-12 ES	12	G 3/8	19.0	22.0	20.0	31.0	41.7
110456	61.012-12 ES	12	G 1/2	19.0	26.0	24.0	33.0	53.4

Assembling instructions for push-in fittings

- Cut the hose ends plain. To ensure an ideal sealing effect and secure stop of the fitting make sure the hose end is not oval.
- Clean the hose ends and make sure that it is free of burrs.
- Push the hose ends into the fitting till it stops.
- Test stability by pulling the hose shortly.
- Push the release ring to release the hose.
- Pull out the hose with slight rotation.
- For a new assembling cut the hose plain again. Then pushing and releasing the tube should not be affected adversely.